

1		2	3	4
RevNo	Revision note			Date
				Signature
				Checked

A
B
C
D
E
F

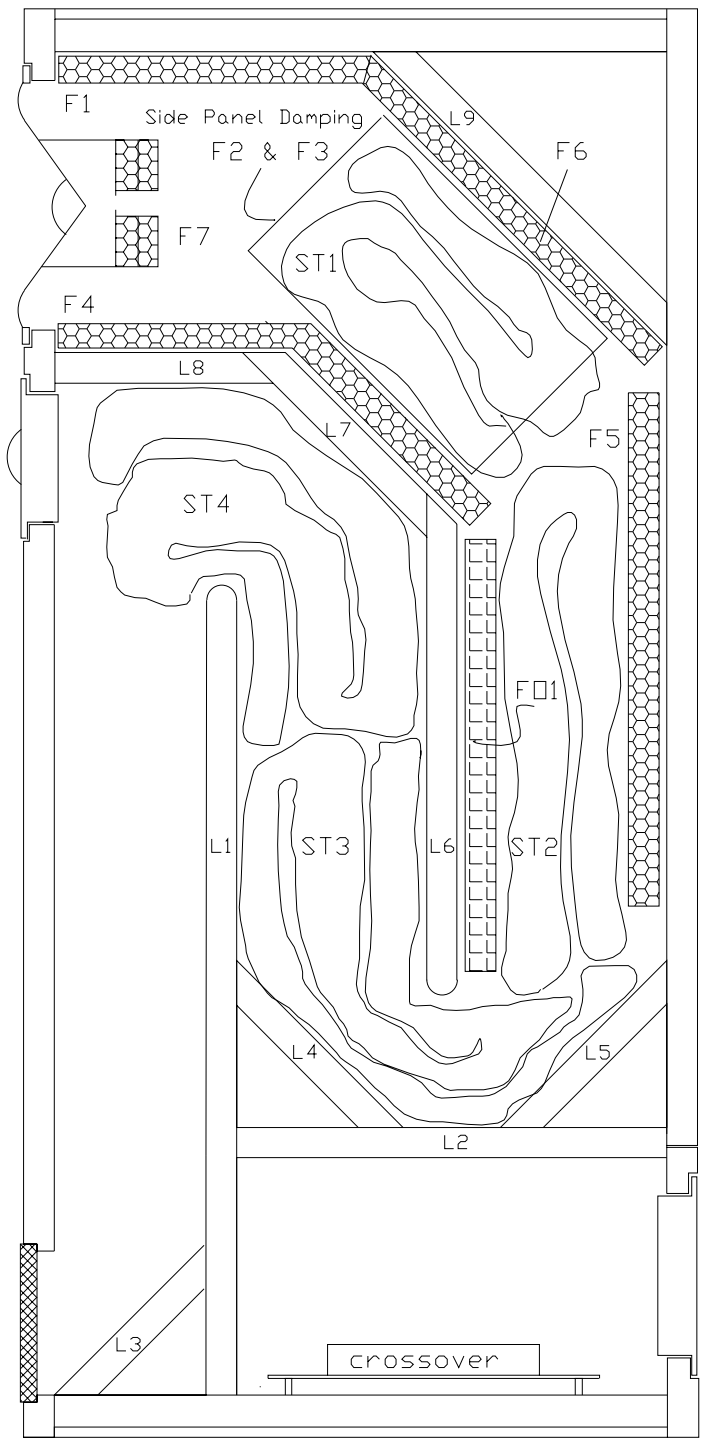

Fig(1) GENERAL ASSEMBLY.

Itemref	Quantity	Title/Name, designation, material, dimension etc			Article No./Reference	
Designed by B. J. Adams	Checked by	Approved by - date	Filename See below	Date 23/03/2001	Scale NONE	
QTA SYSTEMS			TL1/2 GENERAL ASSEMBLY			
			ASSYTL12FIG1.DWG		REV 00	SHEET 1/9

1	2	3	4
RevNo	Revision note	Date	Signature
			Checked

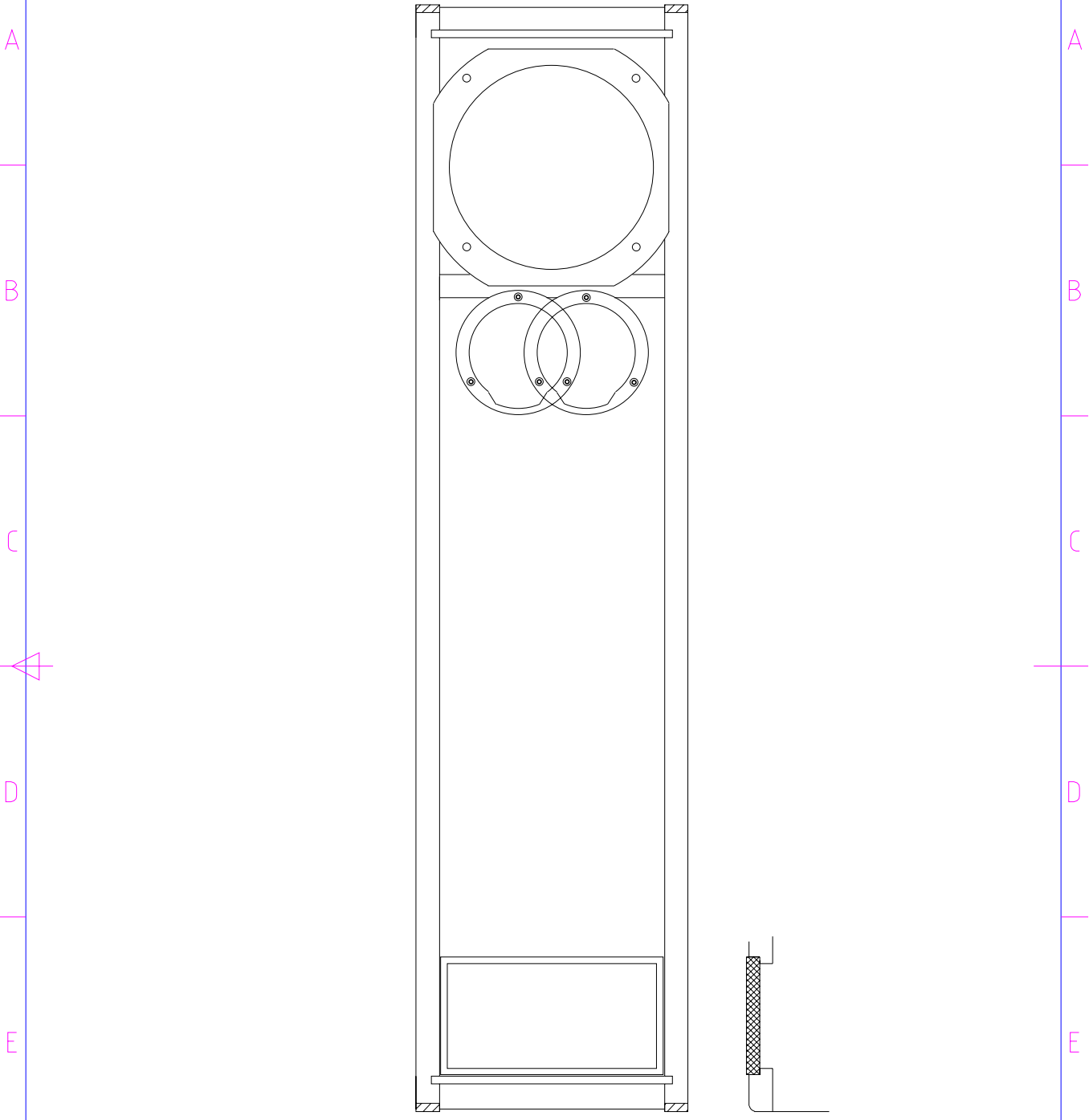

FIG(1a) GENERAL ASSEMBLY

Itemref	Quantity	Title/Name, designation, material, dimension etc			Article No./Reference	
Designed by B. J. Adams	Checked by	Approved by - date	Filename See below	Date 23/03/2001	Scale NONE	
QTA SYSTEMS			TL1/2 GEN ASSY FRONT PANELS			
			ASSYTL12FIG1A.DWG	REV 00	SHEET 3/9	

1	2	3	4
RevNo	Revision note	Date	Signature
			Checked

BASIC GLUING SEQUENCE

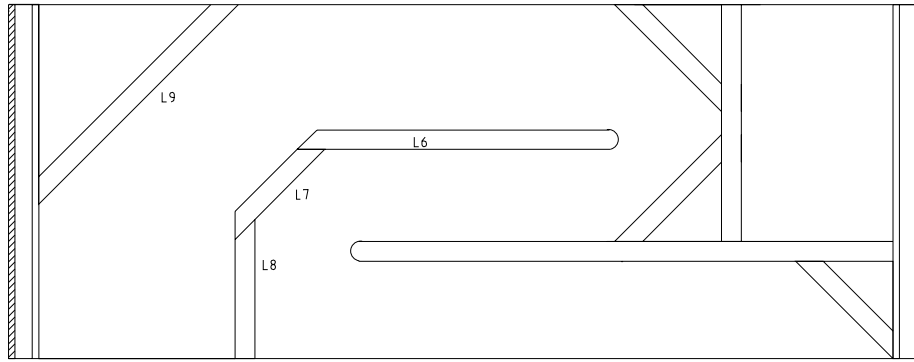

FIG(2) DRY ASSEMBLY



INSERT TOP UNGLUED FOR JIGGING PURPOSES

MUST BE FLUSH

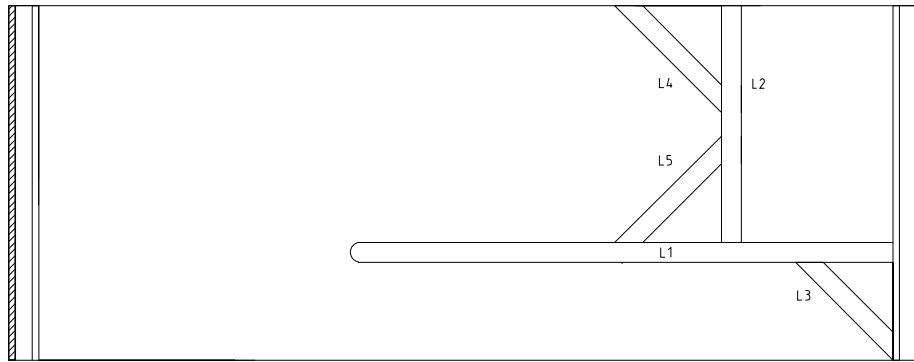

FIG(3) FIRST STAGE GLUING.

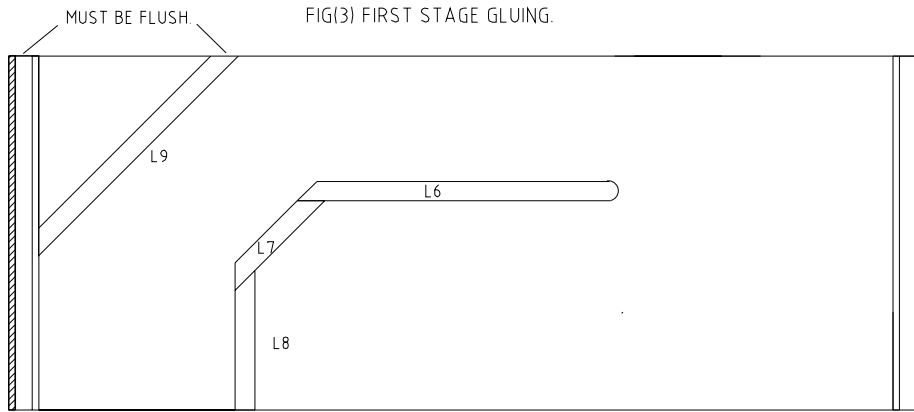

FIG(3) SECOND STAGE GLUING.

Itemref	Quantity	Title/Name, designation, material, dimension etc	Article No./Reference		
Designed by B. J. Adams	Checked by	Approved by - date	Filename See below	Date 23/03/2001	Scale NONE
QTA SYSTEMS			TL1/2 ASSEMBLY / GLUING DETAIL		
			ASSYTL12FIG23.DWG	REV 00	SHEET 4/9

1	2	3	4
RevNo	Revision note	Date	Signature
			Checked

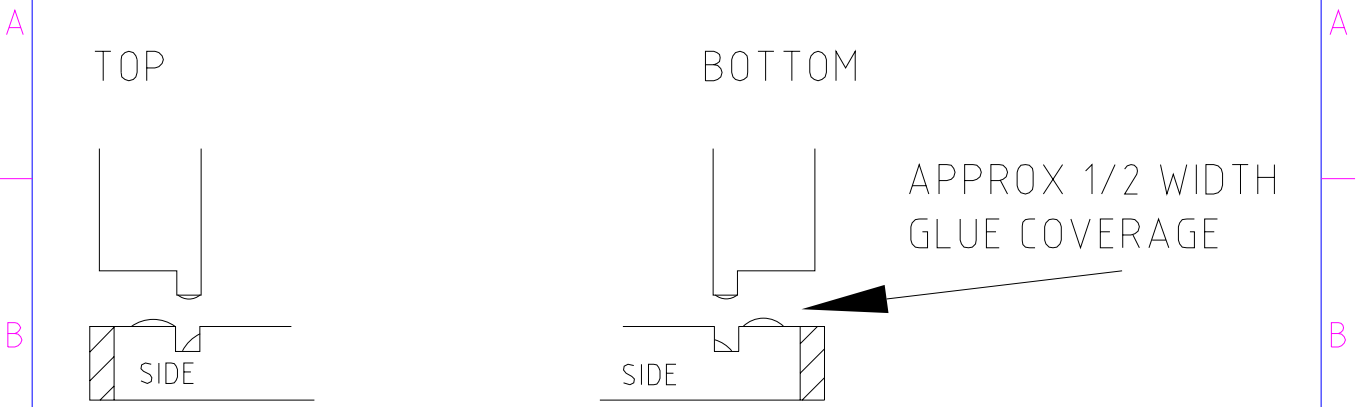

FIG(4) GLUE POSITIONS, TOP & BOTTOMS

Itemref	Quantity	Title/Name, designation, material, dimension etc			Article No./Reference	
Designed by B. J. Adams	Checked by	Approved by - date	Filename See below	Date 23/03/2001	Scale NONE	
QTA SYSTEMS			TL1/2 GLUE DETAILS TOP & BOTTOMS			
			ASSYTL12FIG4.DWG	REV 00	SHEET 5/9	

1		2	3	4
RevNo	Revision note		Date	Signature
				Checked

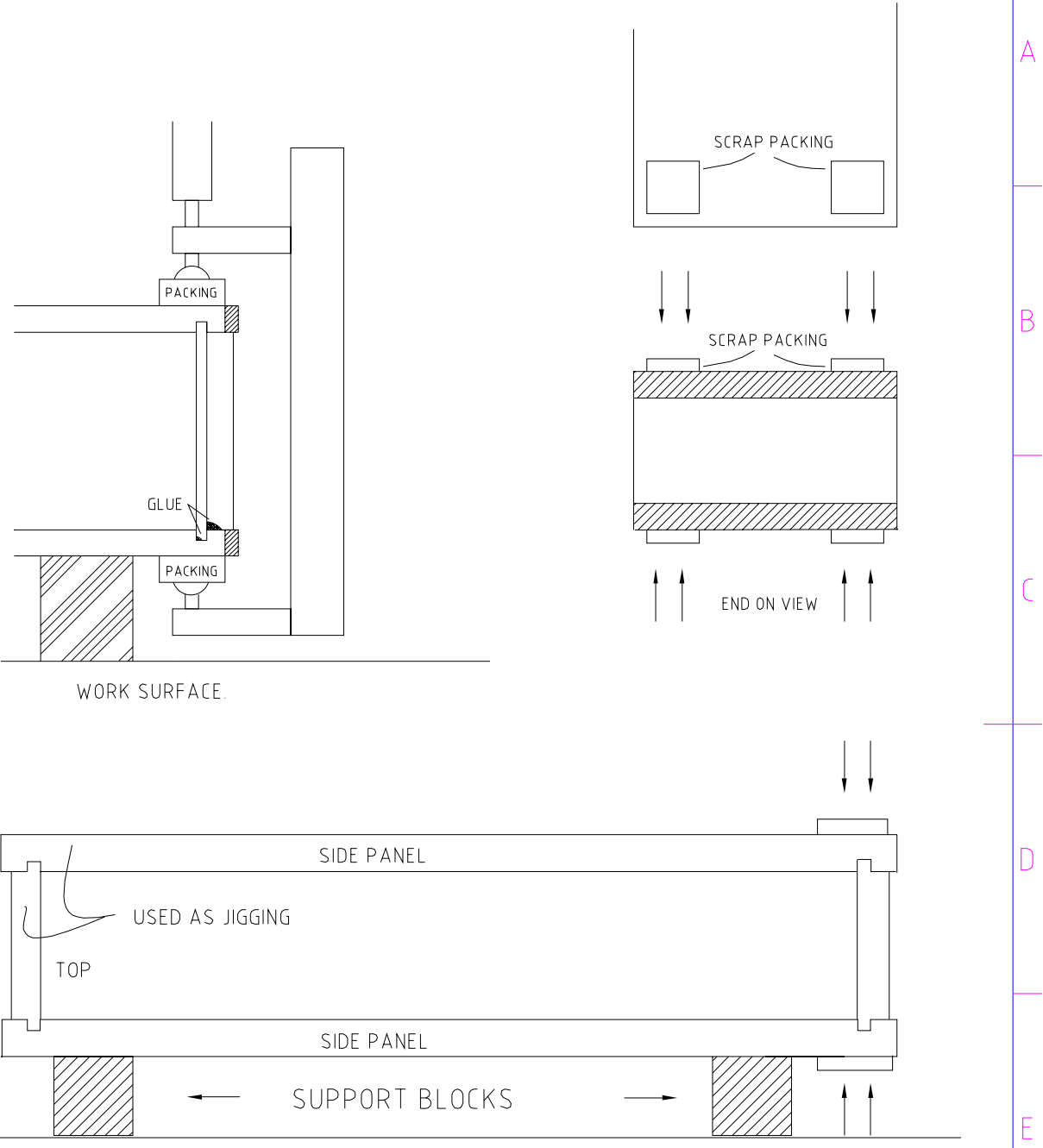

FIG(5) CLAMPING THE ARRANGEMENT

Itemref	Quantity	Title/Name, designation, material, dimension etc			Article No./Reference	
Designed by B. J. Adams	Checked by	Approved by - date	Filename See below	Date 23/03/2001	Scale NONE	
QTA SYSTEMS			TL1/2 SIDE PANEL CLAMPING			
			ASSYTL12FIG5.DWG	REV 00	SHEET 6/9	

1	2	3	4
RevNo	Revision note	Date	Signature
			Checked

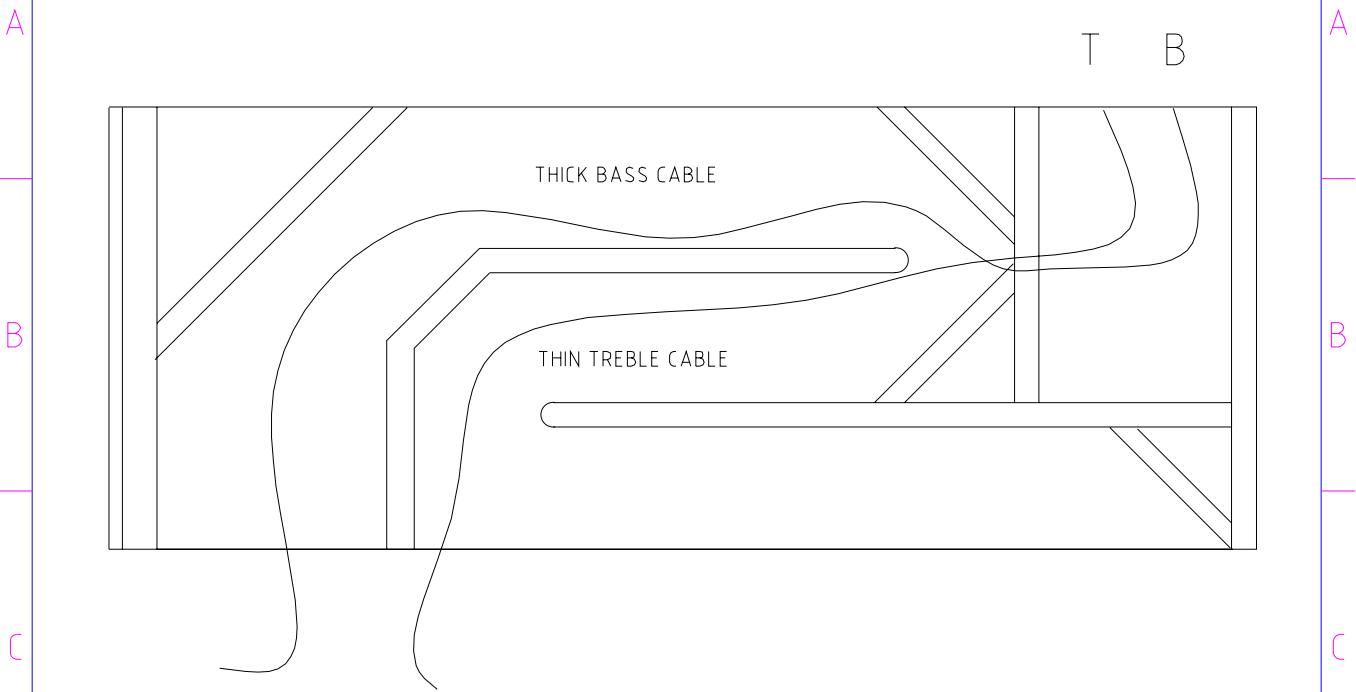
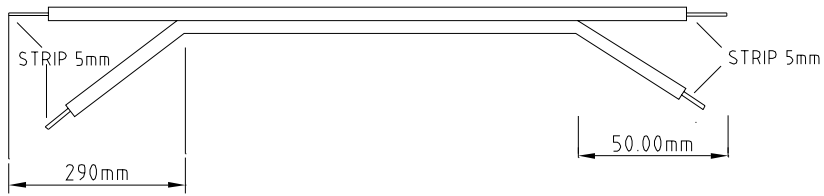

FIG (6) CABLE LAYOUT.



CABLE END DETAILS

Itemref	Quantity	Title/Name, designation, material, dimension etc			Article No./Reference	
Designed by B. J. Adams	Checked by	Approved by - date	Filename See below	Date 23/03/2001	Scale NONE	
QTA SYSTEMS			TL1/2 CABLE LAYOUTS			
			ASSYTL12FIG6.DWG	REV 00	SHEET 7/9	

1	2	3	4
RevNo	Revision note	Date	Signature
			Checked

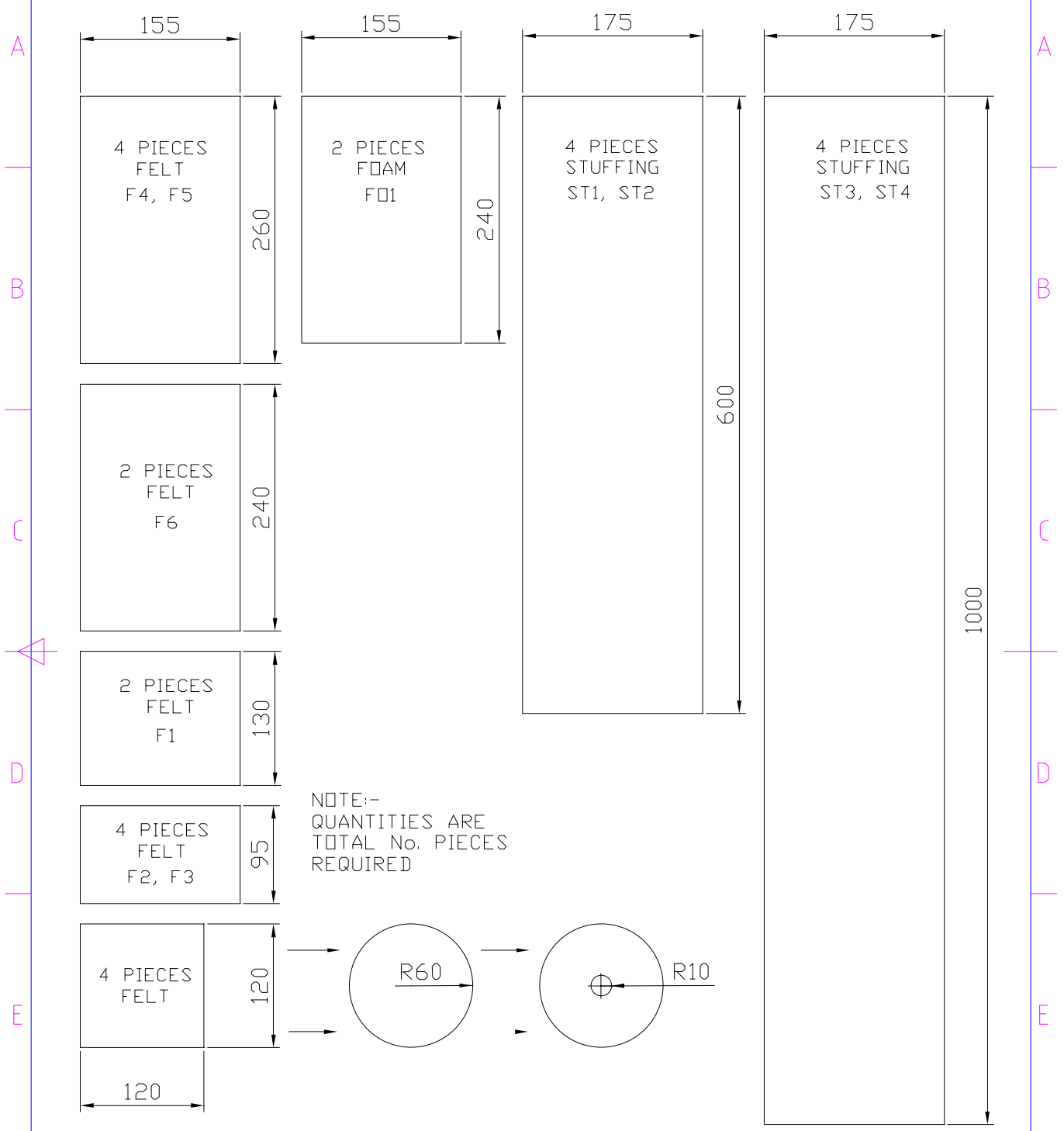

NOTE:-
 QUANTITIES ARE
 TOTAL No. PIECES
 REQUIRED

FIG (7) DAMPING PADS ETC.

Itemref	Quantity	Title/Name, designation, material, dimension etc		Article No./Reference	
Designed by B. J. Adams	Checked by	Approved by - date	Filename See below	Date 29/03/01	Scale NONE
QTA SYSTEMS			TL1/2 INTERNAL DAMPING MTRLS		
			ASSYTL12FIG7.DWG	REV 00	SHEET 8/9

1	2	3	4
RevNo	Revision note	Date	Signature
			Checked

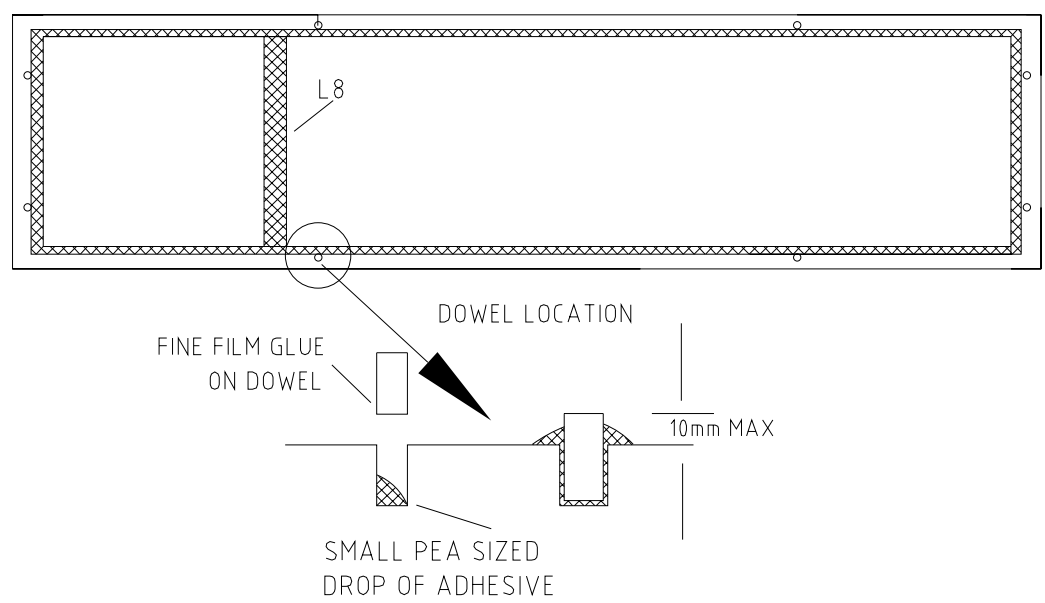

FIG(8) FRONT PANEL GLUE DISPERSION, MAIN BODYWORK

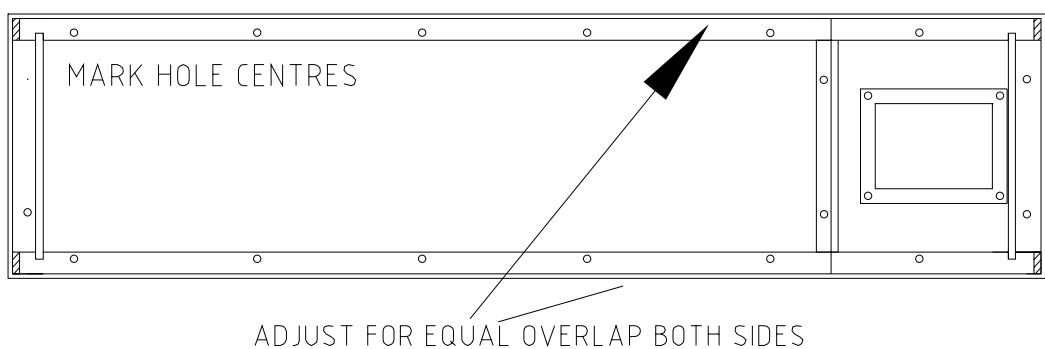

FIG(9) MARKING OUT REAR PANEL SCREW LOCATIONS

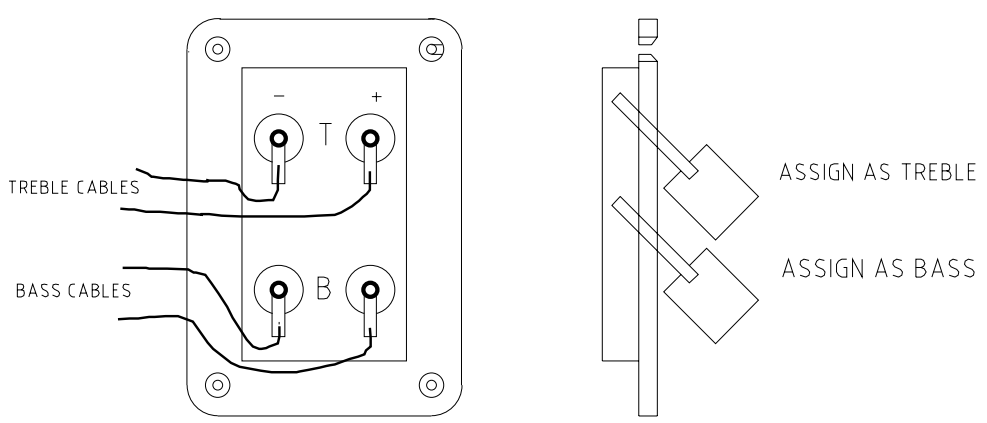

FIG(10) TERMINAL TRAY WIRING

Itemref	Quantity	Title/Name, designation, material, dimension etc		Article No./Reference	
Designed by B. J. Adams	Checked by	Approved by - date	Filename See below	Date 23/03/2001	Scale NONE
QTA SYSTEMS			TL1/2 FRONT & REAR PANEL GLUING		
			ASSYTL12FIG8910.DWG	REV 00	SHEET 9/9

1	2	3	4
RevNo	Revision note	Date	Signature
			Checked

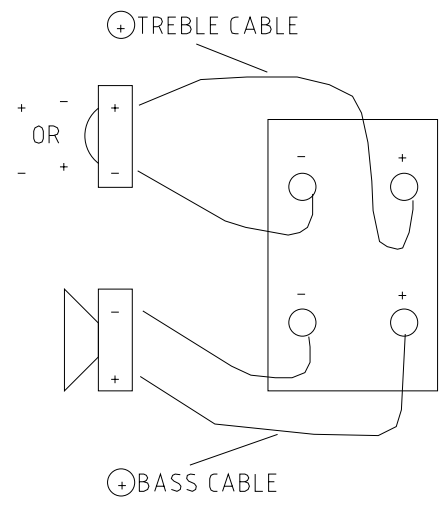

FOCAL 7V4211DB OR 7K4211DB
3rd ORDER PASSIVE XOVER

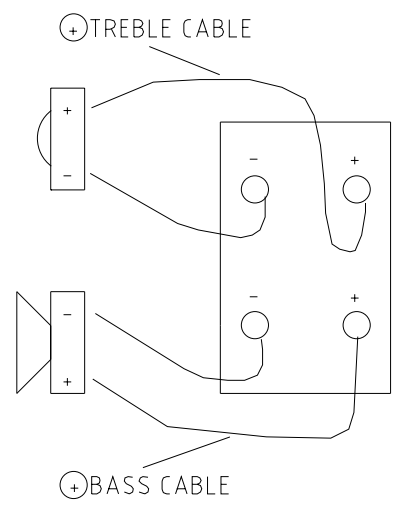

SCAN SPEAK 18W/8545K00
2nd ORDER PASSIVE XOVER

FIG(11) CABLE WIRING POLARITY

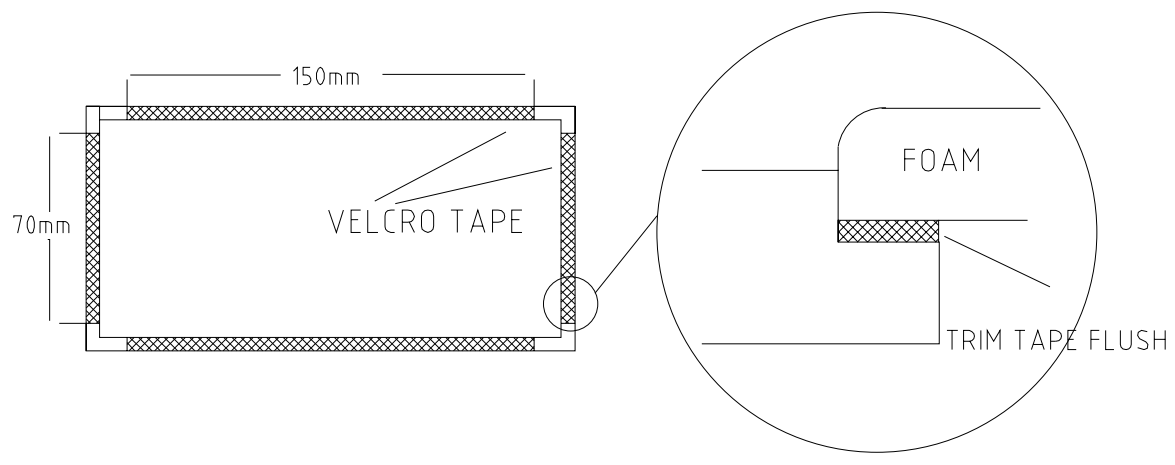

FIG(12) FITTING FRONT GRILLE

Itemref	Quantity	Title/Name, designation, material, dimension etc			Article No./Reference	
Designed by B. J. Adams	Checked by	Approved by - date	Filename See below	Date 23/03/2001	Scale NONE	
QTA SYSTEMS			TL12 GRILLES AND WIRES			
ASSYTL12FIG1112.DWG				REV 00	SHEET 2/9	